

GB User Instructions

Set Back Radiator Thermostat

The RA PLUS-w is a radiator thermostat with an electronic control. The radiator thermostat is set to the desired room temperature by the user and the thermostat automatically maintains the set temperature. Using the electronic control module temperatures are reduced by 3°C at selected periods of the day and at night.

The radiator thermostat communicates wireless with Z-wave compatible home controls.

Fitting the radiator thermostat

The sensor can be fitted directly to all Danfoss RA 2000 radiator valves by means of a snap-lock mechanism.

To remove the thermostat turn the locking ring anti-clockwise to release the snap-lock mechanism.

Setting the desired room temperature

To set the "Comfort" or day time temperature adjust the handle to the left or right. The table shows the relationship between the setting number and the approximate room temperature obtained.

If no heating is required turn handle fully clockwise until the snowflake symbol aligns with the setting pointer. This ensures a room temperature not lower than 7-8°C.

Activating the Z-wave module

Z-wave modules must be assigned to the controller before any remote control functions can be accomplished. When the red battery protection strip has been removed, the LED is lit for 1 second and the module is ready to be assigned.

Communication with the home controller

1. Set home controller in "Ready for inclusion" mode.
2. Press sun/moon button 3 times. LED flashes until radio contact is obtained. Failure is indicated with 6 slow flashes.
3. Controller displays "new hardware found", and the thermostat can be named and assigned to the relevant room.
4. The thermostat is ready to receive information on setback periods.

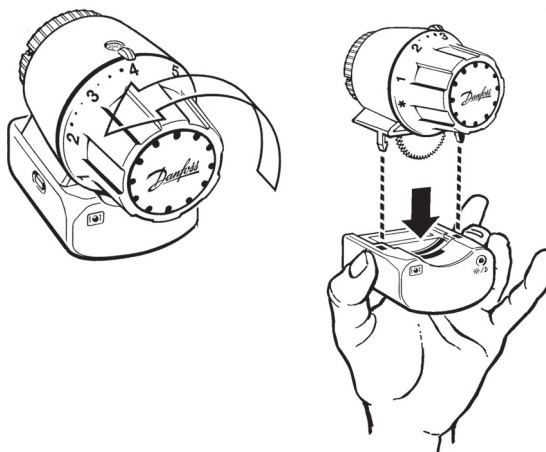
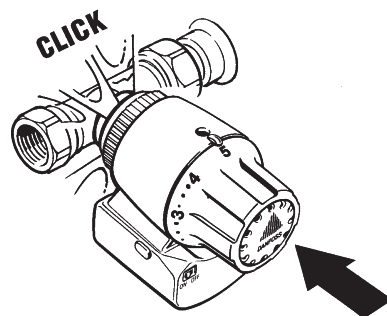

Push button (Sun/moon)

1x short push	Switch sun/moon setting
3x short push	Inclusion/exclusion
1 push for 5 sec.	Link test

LED flash pattern

Fast flashes	Inclusion/exclusion
Constant light	Link test
Slow flashes	Action failed
Flashing stops	Action succeeded
Short flash	Replace batteries

Removing and resetting the Z-wave module

To remove the module press in both module retention buttons on the sides of the unit and gently pull module away from the sensor unit. The reset button is pressed using a slim pen. This deletes all settings.

Battery replacement

When batteries are low and in need of replacement the LED flashes shortly and the home system displays a warning. To remove the module press in both module retention buttons on the sides of the unit and gently pull module away from the sensor unit. Communication with the Z-wave controller is retained if battery change is completed within two minutes. Batteries should then be replaced with high quality alkaline cells size AA /L6R.

Important: Incorrect orientation of batteries may damage the module

If batteries are changed without removing the module, the sun/moon push button should be pressed a few times before inserting new batteries.

Specifications

Power supply	2x MN1500/LR6 Alkaline batteries
Programmes	Max. 4 heat periods per 24 hours
Communication / frequency	Wireless Z-Wave / 868,42 MHz
Transmission power	<10mW
Transmission distance	Ca. 30m (free sight)
Transport temperature	from -20 to 60° C
Weight	320 g
Approvals	CEN, EMC, R&TEE